

TS-120-G-A-1

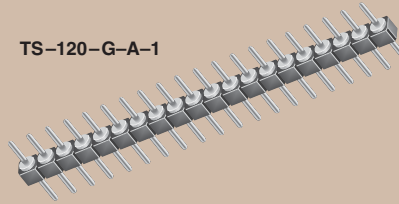

TD-108-G-AA

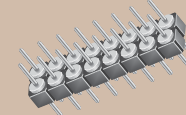

(2,54mm) .100"

TS, TD, HTS SERIES

# PRECISION MACHINED TERMINAL STRIPS

## SPECIFICATIONS

For complete specifications see [www.samtec.com?TS](http://www.samtec.com?TS) or [www.samtec.com?TD](http://www.samtec.com?TD)

### TS, TD

**Insulator Material:** Black G.F. Polyester  
**Terminal Material:** Brass, except Style G is Phosphor Bronze  
**Plating:** Au over 50µ" (1,27µm) Ni or Sn over 100µ" (2,54µm) Cu or 50µ" (1,27µm) Ni  
**Operating Temp Range:** -55°C to +125°C with Gold -55°C to +105°C with Tin  
**Current Rating:** 1A  
**RoHS Compliant:** Yes  
**Lead-Free Solderable:** Wave only



## SPECIFICATIONS

For complete specifications see [www.samtec.com?HTS](http://www.samtec.com?HTS)

### HTS

Same as TS except:  
**Insulator Material:** Black Liquid Crystal Polymer  
**Lead-Free Solderable:** Wave, or reflow with all Au



**Mates with:** SS, SD, HSS, SL, SDL, ESS, ESD

**Note:** Some lengths, styles and options are non-standard, non-returnable.

TYPE STRIP

1

NO. PINS PER ROW

PLATING OPTION

LEAD STYLE

**TS**  
= Single Row Terminal Strip

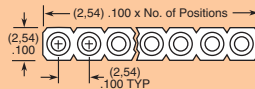

**HTS**  
= Single Row High Temp Terminal Strip

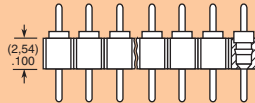

**TD**  
= Double Row Terminal Strip

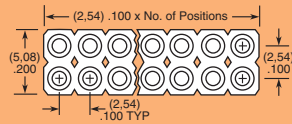

**-G**  
= 20µ" (0,51µm) Gold  
Except -J & -L are 10µ" (0,25µm) Gold

**-T**  
= Tin

**01 thru 32**  
=TS Series

**01 thru 36**  
=HTS & TD Series

## -AA

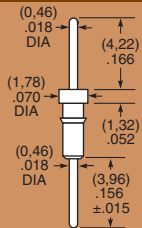

Component No. = T-1R5-

## -A, -A-1, -A-2

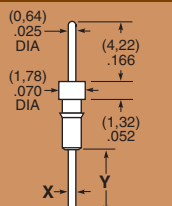

-A Component No. = T-1R0-  
-A-X Component No. = T-1R7

LEAD STYLE	X (DIA)	Y (±.015)
-A	(0,46) .018	(3,96) .156
-A-1	(0,64) .025	(5,33) .210
-A-2	(0,89) .035	(5,33) .210

## -C, -C-1, -C-2

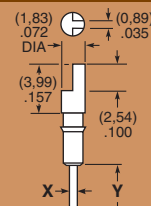

-C Component No. = T-1R2-  
-C-X Component No. = T-1R9-

LEAD STYLE	X (DIA)	Y (±.015)
-C	(0,46) .018	(3,96) .156
-C-1	(0,64) .025	(5,33) .210
-C-2	(0,89) .035	(5,33) .210

## -G-1

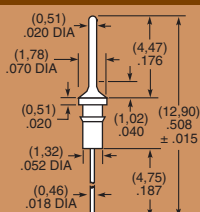

Component No. = T-1R5-

## -J

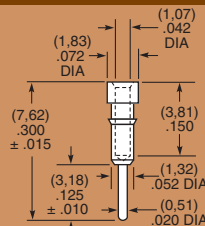

Component No. = S-1P1-

## -L-1, -L-2, -L-3

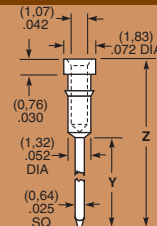

Component No. = S-1W1

LEAD STYLE	Y (DIA)	Z (±.015)
-L-1	(12,95) .510	(17,86) .703
-L-2	(9,14) .360	(14,05) .553
-L-3	(6,60) .260	(11,51) .453

Due to technical progress, all designs, specifications and components are subject to change without notice.

[WWW.SAMTEC.COM](http://WWW.SAMTEC.COM)